

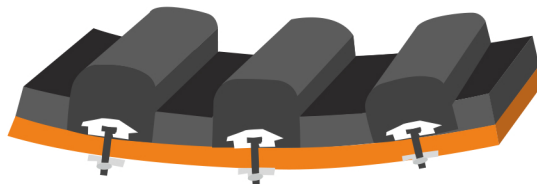

**SAKAR Rub-Tech Pvt. Ltd.**

Mfg. Ball Mill Rubber Lining

RISING THROUGH QUALITY...

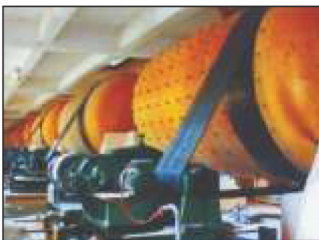
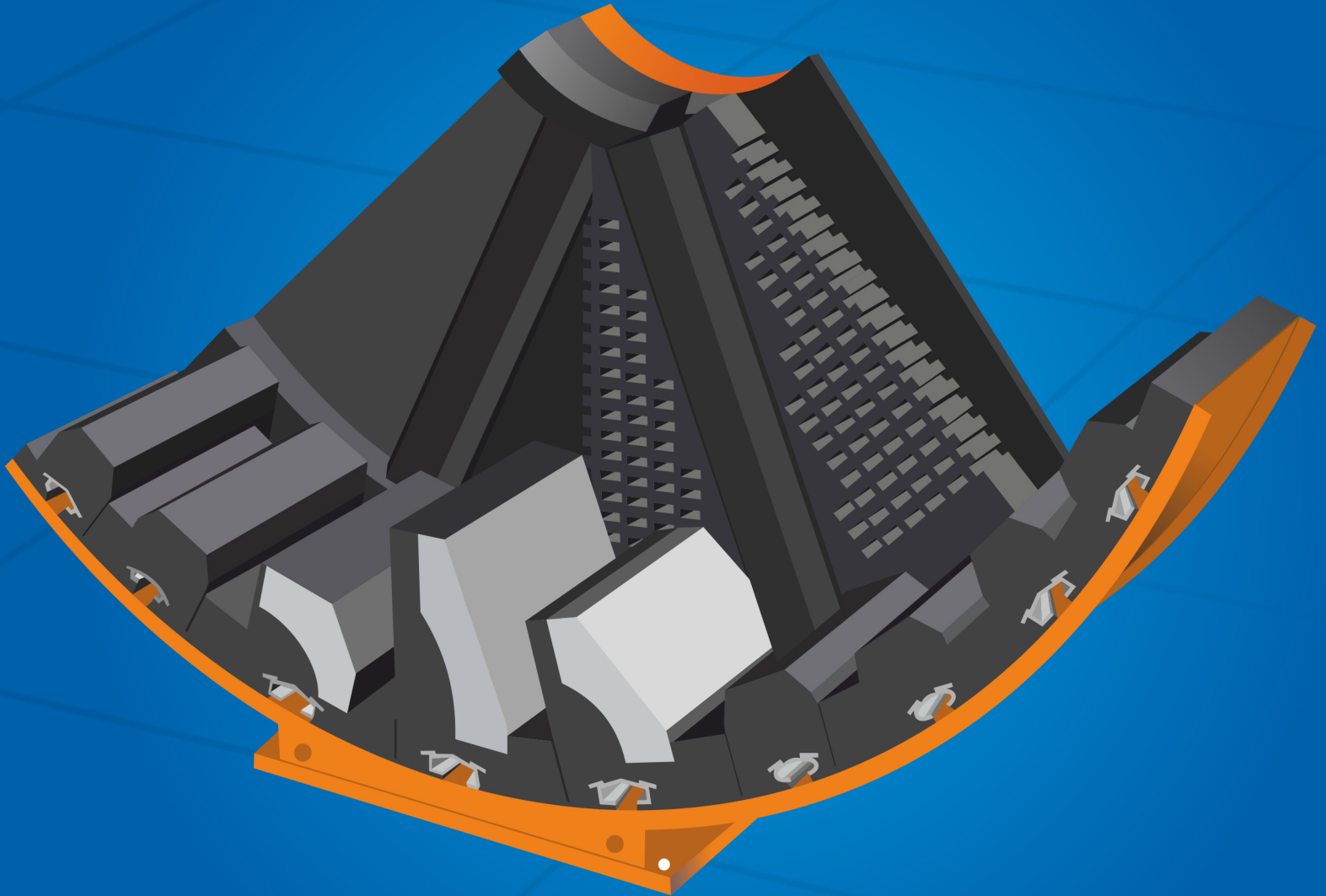

[www.sakarrubtech.com](http://www.sakarrubtech.com)

## SHELL LINER :

**Description:** Ball mill shell liners are used to protect the inner shell of cylinder from being impacted and worn directly by material and grind-ball. At the same time we can use different forms of shell liners to adjust the direction of ball mill motion to improve the grinding effect of the grinding media to material, and to help the ball mill to improve the grinding efficiency, increase production and reduce power consumption. The product provide by SAKAR rub-tech ensure the greatest wear resistance and tenacity to protect the inner shell of cylinder, reduce the maintenance times and prolong the service intervals of ball mill. We can provide customized products according to client's requirement.

### Specification:

Model	CL 350	CL 360	CL 370	CL 380	CL 385	CL 380-1	IL 300
L	1130 mm	1130 mm	1130 mm	1130 mm	1130 mm	1220 mm	1220 mm
W	350 mm	360 mm	370 mm	380 mm	385 mm	380 mm	300 mm
H	80 mm	80 mm	80 mm	80 mm	80 mm	80 mm	40 mm

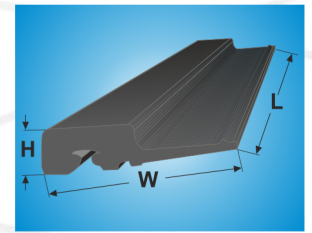

Combo Liner

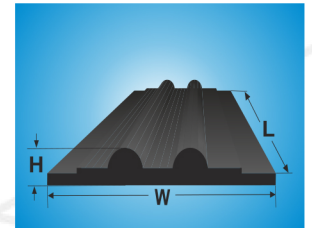

Italic Liner

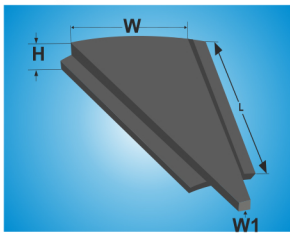

Regular Head Liner

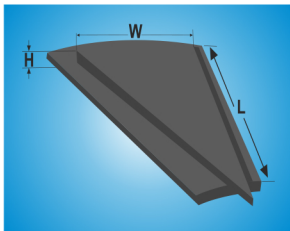

Offset Head Liner

## HEAD LINERS (TRIANGLE):

**Description:** This product is an important part for conical ball mill and its call “ feed end liners for ball mill” its main function is to protect the end cover of ball mill. The high wear-resistance head liner provided by our company have improved the wear condition of the feed end liners for ball mill, that make the end liners have good wear-resistance and effectively increase the service life. We can also make customized products according to client design.

### Specification:

MODEL	RT 440	RT 550	OT 385	OT 415
L	1140 mm	1270 mm	1090 mm	1255 mm
W	440 mm	550 mm	385 mm	415 mm
W1	50 mm	60 mm	--	--
H	50 mm	55 mm	50 mm	50 mm

## LIFTER BAR FOR SHELL LINER & HEAD LINER:

**Description:** As a liner, the lift bar is used to protect ball mill head from direct impact and friction by grinding medium and material. This kind of Mill Lifter Liner is widely used in all kinds of working condition to increase grinding efficiency and production and reduce consumption of metal. We are able to provide customise this lifter bar conforming to customer's requirements & by using combination of liner and lifter user can rotate the ball mill both clockwise & anti clockwise easily.

### Specification:

MODEL	RL 122	OL 142
L	1270 mm	1190 mm
W	122 mm	142 mm
H	75 mm	80 mm

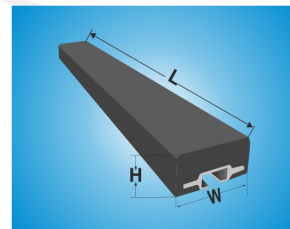

Regular Lifter

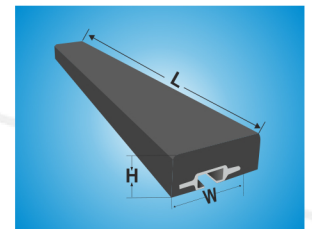

Offset Lifter

### COMBINATION OF TRIANGLE & LIFTER BAR:

	TRIANGLE	LIFTEL	TRIANGLE	LIFTER	TRIANGLE	LIFTER	TRIANGLE	LIFTER
MODE	RT 440	RL 122	RT 550	RL 122	OT 385	OT 142	OT 415	OL 142
L	1140 mm	1140 mm	1270 mm	1270 mm	1090 mm	1090 mm	1255 mm	1190 mm
W	440 mm	122 mm	550 mm	122 mm	385 mm	142 mm	415 mm	142 mm
W1	50 mm	--	60 mm	--	--	--	--	--
H	50 mm	75 mm	55 mm	75 mm	50 mm	80 mm	50 mm	80 mm

## SIDE WALL CIRCLE:

### Description:

This Product is also call blind disk for Ball Mill. It is a round plate which has all of the relevant bolt holes but no centre hole, and because of this feature Disk is used to close off the end of Ball mill.

### Specification:

MODEL	CR 950	CR 1050
D1	950 mm	1080 mm
D2	850 mm	980 mm
H	40 mm	40 mm

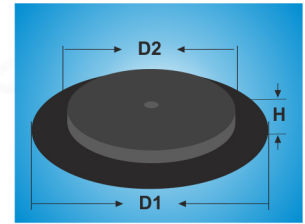

## RUBBER PLUG :

### Specification:

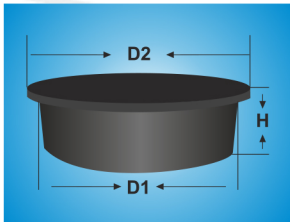

Model	RP 370	RP 570	RP 630	RP 670	RP 680
D1	310 mm	490 mm	550 mm	590 mm	600 mm
D2	370mm	570mm	630mm	670mm	680mm
H	Available with 150mm & 200 mm Height				

## BALL MILL FILLING SEGMENT:

**Description:** The ball mill filling segment is used to fill the gap which cannot be covered by rubber liners and prevent the leaking of mud or other grinding materials and that protect the ball Mill.

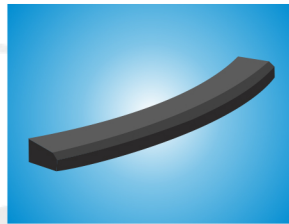

## WATER SCRAPER FOR WALL TILES

**Description :** Sakar Supply this Product to Clean wall tiles at final stage to remove unwanted dust during production.

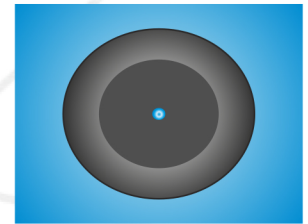

## RUBBER FRAME :

### Specification:

MODEL	FL 1000	FL 710
L	1000 mm	710 mm
W	800 mm	545 mm
H	75 mm	75 mm
D	550 mm	

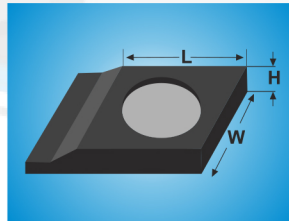

## FITTING ACCESSORIES:

SAKAR supply all fastening components required for mill liner change outs, including:

- T Bolts & Clamp Blocks
- Cup Washers
- Integral Sealing Rubber Washers



## ADVANTAGES:

1. **Longer Wearlife :** SAKAR's Rubber Liners are pressure molded to ensure highest density and engineered for maximum abrasion resistance. Industry recognized as delivering 1.5 – 4 times the wearlife of metal liners.
2. **Strong Corrosion Resistance :** The ball mills are more easily being corroded by pulp in wet grinding process. While SAKAR's rubber liners can well resistant the corrosion of acid and alkalis material, water or other solutions under a certain temperature of 90°C -100°C.
3. **Reduced Weight Lower Costs :** Our Rubber Liners are 75 to 80% lighter than steel liners , increasing energy efficiency of the ball mill by 15%. Less stress on the mill for reduced maintenance.
4. **Leak Proof :** Rubber liners are perfectly sealed to eliminate opportunity for slurry leakage and corrosion of the shell.
5. **Easy to Install :** Quick and easy installation of light weight liners minimizes downtime and improves safety.
6. **Reduce Noise Levels:** Reduce noise level by 8 – 10 dB. Environment friendly for safer working condition.
7. **Customized to Suit :** SAKAR's Rubber Liners are customized and perfect-fit design to improve your bottom lines.
8. **Easy Inventory Control :** Predictable wear life of Rubber Liners allow for advanced ordering and deliveries providing additional cost saving. Call SAKAR for more information.

## ABOUT US

SAKAR Rub-tech is owned and operated by Mr Manish Pajapati & Mr.Babubhai Pajapati who is having 15 years experience of rubber industry. SAKAR Rub-tech provides excellent grinding solution through rubber lining in ball mill all over ceramic and mining industries. SAKAR take care of ball mill with wear & tear and abrasion resistance rubber products. We strictly follow our principal of "Always deal with quality product only". We always strive to provide quality and robust products to our customers.

At SAKAR you will find products of great quality and durability design & manufactured by team of engineers having more than 15 years of experience in the same industry under their belt. Our customers always recognize us for quality and optimum product delivery.

**Our Mission :** To serve our best to our customer and grow smartly with team work of our employs.

**Our Vision :** To provide best quality products and after sales service to every ceramic & mining industry and become part of their organization and working closely with customer.

### Product Quality & Service:

Proper selection of polymer as per client's application like Chemical , Temperature, Wear & Tear , Abrasion Resistance etc.

- Dimensional Accuracy.
- Uniform Hardness all over the surface
- Perfect bonding with metal
- Core Optimum Tensile Strength & Elongation
- Prompt delivery as per Schedule.

### QUALITY ASSURANCE FACILITIES ARE AS SHOWN BELOW:

- Hardness Tester
- Tensile Strength
- Dimensional Checking
- Finish and Visual Checking

**Third Party Testing :** We can offer our Products under Third Party testing through local laboratory if necessary.

**Test Certificate and Warranty :** We can give Warranty & Material Test Certificates depending on the product being supplied and required on the basis of Terms & Conditions.

### OUR UP COMING PRODUCTS FOR MINERAL, MINING & CEMENT INDUSTRIES:

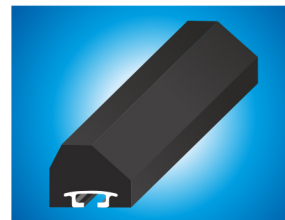
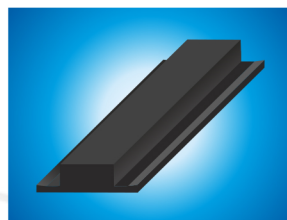
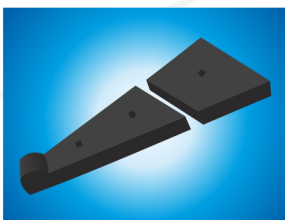
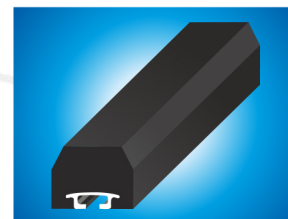
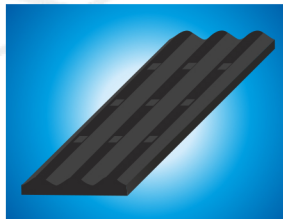
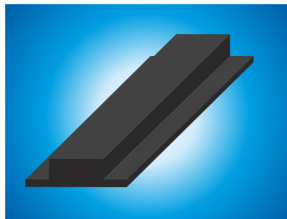

Vibro feeder bellow



**SAKAR Rub-Tech Pvt. Ltd.**

Gujarat Rice Mill Compound Nr. Kirtikunj Society, Dhobighat Road, Dudheswar, Ahmedabad - 380004 Guj. India.

ballmill@sakarrubtech.com I sakar.rubtech@gmail.com www.sakarrubtech.com

Mo. : +91 9825865443

**Note:** Above Specification subjected to change depending on Ball Mill process like wet or dry grinding , cycle type like batch or continues ,grinding media and temperature the rubber material composition will be change and design as per end application.